

# Information for People with Disabilities

## Accessibility

### DFG main office entrance: Kennedyallee 40, Bonn

The building has 6 conference rooms:

▶ Norbert Elias-Saal	> 1st floor / lift beside main stairs	1
▶ Ernst Mayr-Saal	> Ground floor	2
▶ Rahel Hirsch-Saal	> Ground floor	3
▶ Lise Meitner-Saal	> Ground floor	4
▶ Justus v. Liebig-Saal	> Ground floor	5
▶ Theodore v. Kàrmàn-Saal	> Ground floor	6

There are lifts giving unimpeded access to smaller meeting rooms.

There are several accessible toilets for people with disabilities



- ▶ To the left of the main stairs on the ground floor
- ▶ On the 1st floor of the high-rise building / can be reached by lift beside main stairs
- ▶ In the foyer of the “Wissenschaftszentrum” beside the lifts in Tower A; key available at the reception desk

## Floor plan

Ground floor:

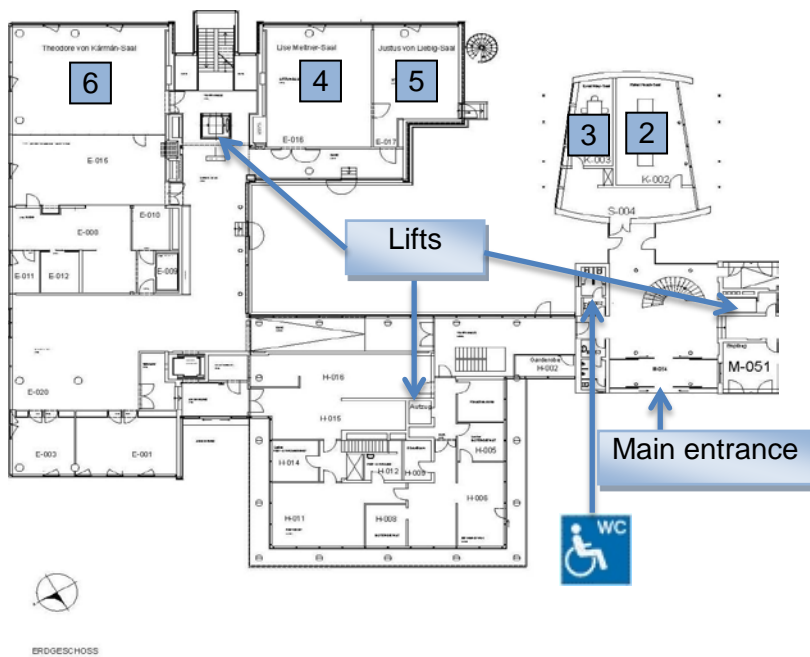

1st floor

